

COMPARISON

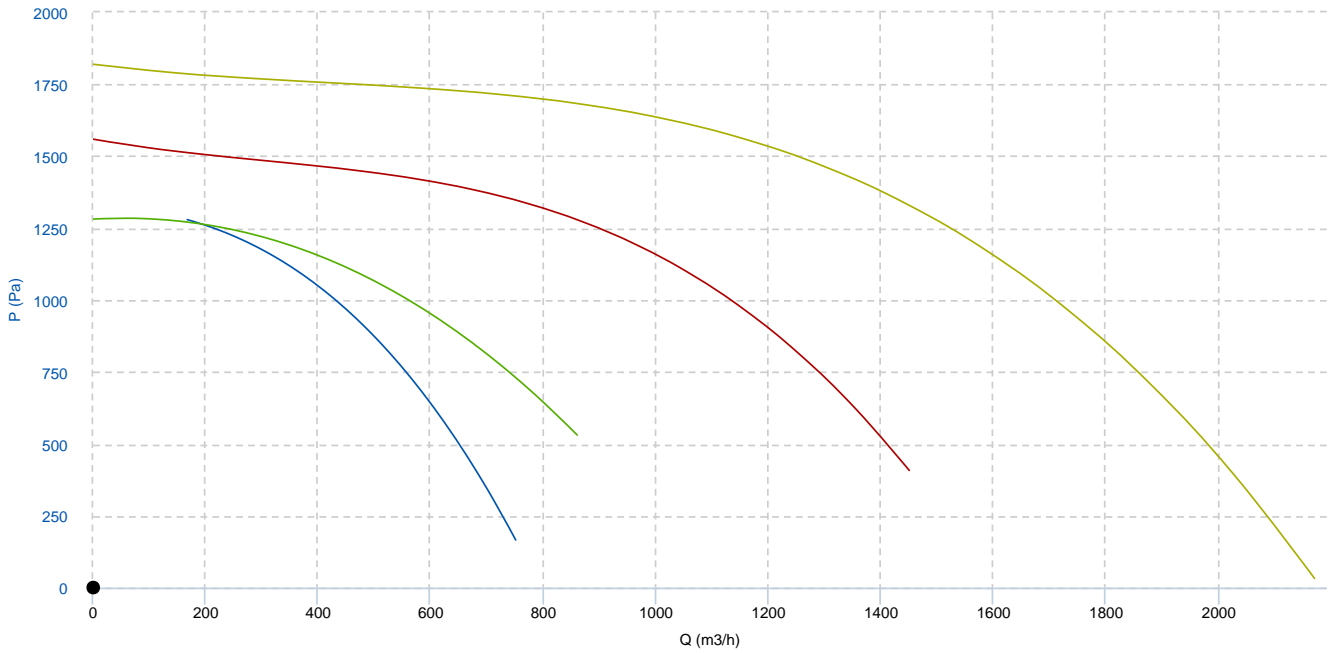

Design point

Q (m ³ /h)	0
P (Pa)	0

comparative summary

model	Q (m ³ /h)	Ps (Pa)	Pt (Pa)	P _{abs} (kW)	P _{recom} (kW)	Efficiency (%)
MAX 26 T2 0,37kW (300951500)	-	-	-	-	-	-
MAX 27 T2 0,55kW (300318200)	-	-	-	-	-	-
MAX 28 T2 1,1kW (300840800)	-	-	-	-	-	-
MAX 31 T2 2,2kW (300886500)	-	-	-	-	-	-

MAX 26 T2 0,37kW (300951500)

GENERAL DATA



CENTRIFUGAL MEDIUM PRESSURE ATEX FAN

MANUFACTURING FEATURES

- Rolling steel sheet housing.
- Cast aluminium impeller.
- Epoxy powder finishing coat.
- Standard asynchronous squirrel-cage motor with IP-55 protection and Class F insulation and ATEX certified EEx-d. Manufactured with standard voltages: 230V 50Hz.
- Standard position LG 270.

APPLICATIONS

- Designed for inline installation, they are suitable for:
- General ventilation in closed environments classified as ATEX zone 2.
 - Maximum working temperature from -20°C to 80°C.

UNDER REQUEST

- 60Hz fans and special voltages.
- Position: LG 0, LG 45, LG 90, LG 135, LG 180 and LG 315.
- ATEX for different categories.

In compliance with the 94/9/CE Directive. ATEX II2G built. Certified II3G with certified ATEX EEx-d II2G motor for areas 2 (gas) or 22 (dust).

CHARACTERISCTIC CURVE

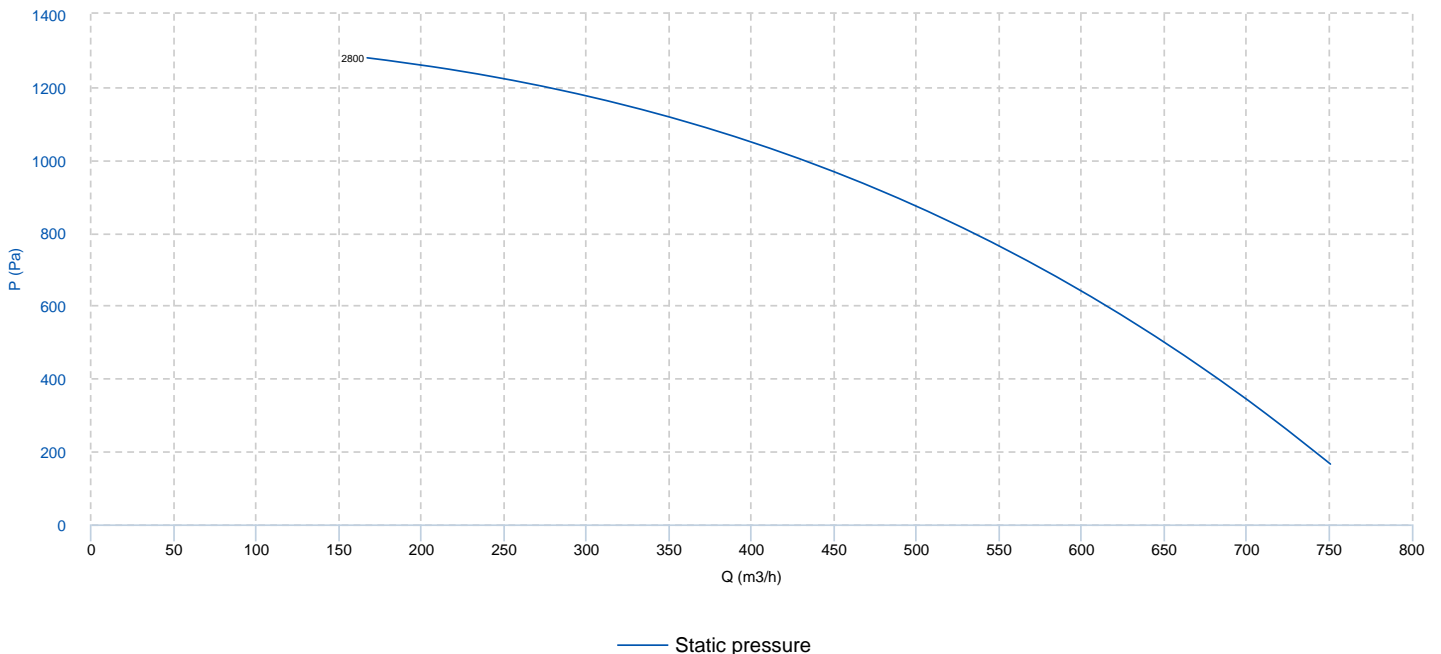

TECHNICAL DATA

fan

RPM	2850
-----	------

approx. weight	13 kg
----------------	-------

max flow	750 m ³ /h
----------	-----------------------

motor

power	0,37 kW
-------	---------

motor rpm	2850
-----------	------

imax 400V	1 A
-----------	-----

size	71
------	----

approx. weight	6 kg
----------------	------

efficiency	71 %
------------	------

FP	0,78
----	------

DIMENSIONS DIAGRAM

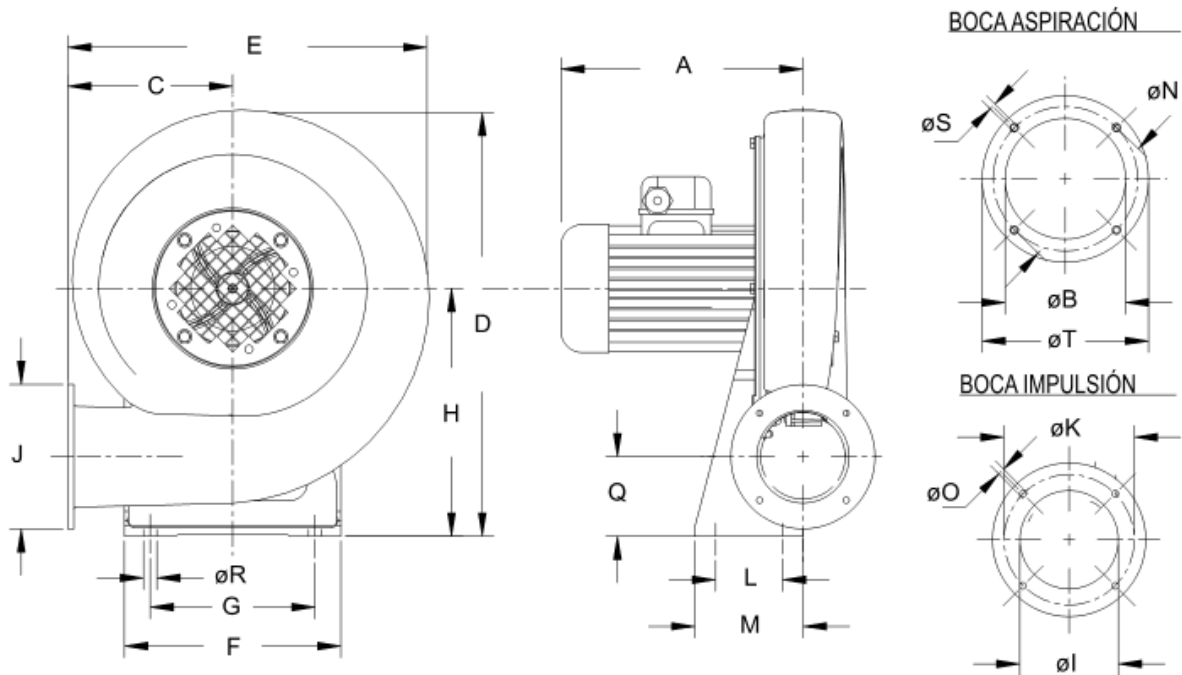

Dimensions (mm)

A	240
D2	402
E	353
J	140
OØ	6,2
TØ	152
Y	460

BØ	110
D3	519
F	210
KØ	119
P	18,5
U	460
Z	406

C	162
D4	473
G	160
L	65
Q	77
V	406

D	413
D5	440
H	240
M	105
RØ	13
W	363

D1	405
D6	431
IØ	90
NØ	132
SØ	6
X	353

MAX 27 T2 0,55kW (300318200)

GENERAL DATA



CENTRIFUGAL MEDIUM PRESSURE ATEX FAN

MANUFACTURING FEATURES

- Rolling steel sheet housing.
- Cast aluminium impeller.
- Epoxy powder finishing coat.
- Standard asynchronous squirrel-cage motor with IP-55 protection and Class F insulation and ATEX certified EEx-d. Manufactured with standard voltages: 230V 50Hz.
- Standard position LG 270.

APPLICATIONS

- Designed for inline installation, they are suitable for:
- General ventilation in closed environments classified as ATEX zone 2.
 - Maximum working temperature from -20°C to 80°C.

UNDER REQUEST

- 60Hz fans and special voltages.
- Position: LG 0, LG 45, LG 90, LG 135, LG 180 and LG 315.
- ATEX for different categories.

In compliance with the 94/9/CE Directive. ATEX II2G built. Certified II3G with certified ATEX EEx-d II2G motor for areas 2 (gas) or 22 (dust).

CHARACTERISCTIC CURVE

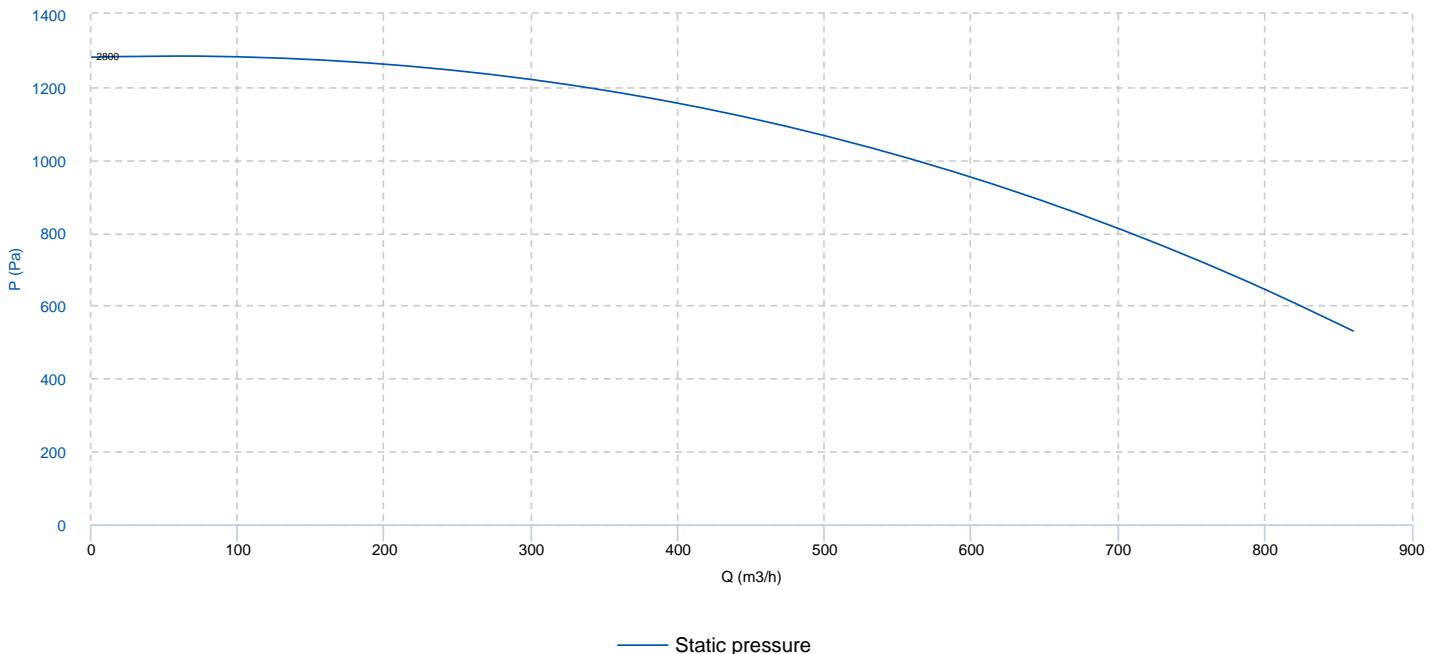

TECHNICAL DATA

fan

RPM	2840
-----	------

approx. weight	14 kg
----------------	-------

max flow	860 m ³ /h
----------	-----------------------

motor

power	0,55 kW
-------	---------

motor rpm	2840
-----------	------

imax 400V	1,45 A
-----------	--------

size	71
------	----

approx. weight	6.5 kg
----------------	--------

efficiency	70 %
------------	------

FP	0,78
----	------

DIMENSIONS DIAGRAM

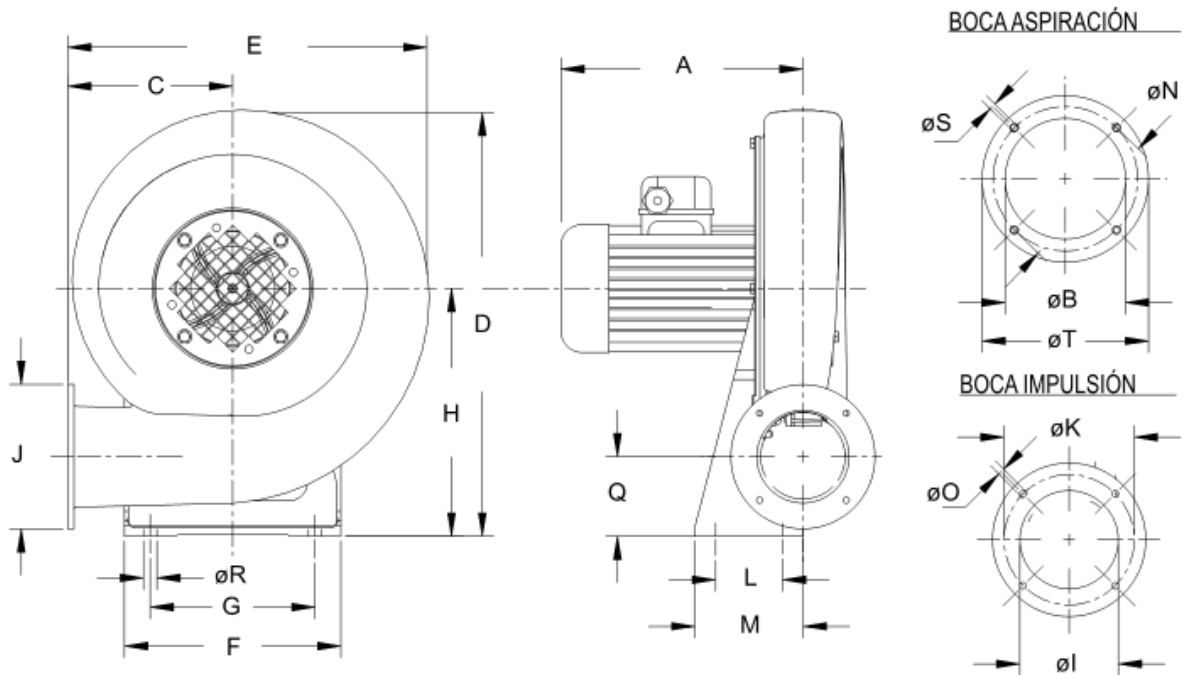

Dimensions (mm)

A	250
D2	428
E	368
J	155
OØ	6,2
TØ	165
Y	482

BØ	125
D3	552
F	220
KØ	129
P	26
U	482
Z	425

C	168
D4	505
G	170
L	80
Q	90
V	425

D	440
D5	470
H	260
M	120
RØ	13
W	381

D1	431
D6	460
IØ	100
NØ	147
SØ	6
X	168

MAX 28 T2 1,1kW (300840800)

GENERAL DATA



CENTRIFUGAL MEDIUM PRESSURE ATEX FAN

MANUFACTURING FEATURES

- Rolling steel sheet housing.
- Cast aluminium impeller.
- Epoxy powder finishing coat.
- Standard asynchronous squirrel-cage motor with IP-55 protection and Class F insulation and ATEX certified EEx-d. Manufactured with standard voltages: 230V 50Hz.
- Standard position LG 270.

APPLICATIONS

- Designed for inline installation, they are suitable for:
- General ventilation in closed environments classified as ATEX zone 2.
 - Maximum working temperature from -20°C to 80°C.

UNDER REQUEST

- 60Hz fans and special voltages.
- Position: LG 0, LG 45, LG 90, LG 135, LG 180 and LG 315.
- ATEX for different categories.

In compliance with the 94/9/CE Directive. ATEX II2G built. Certified II3G with certified ATEX EEx-d II2G motor for areas 2 (gas) or 22 (dust).

CHARACTERISCTIC CURVE

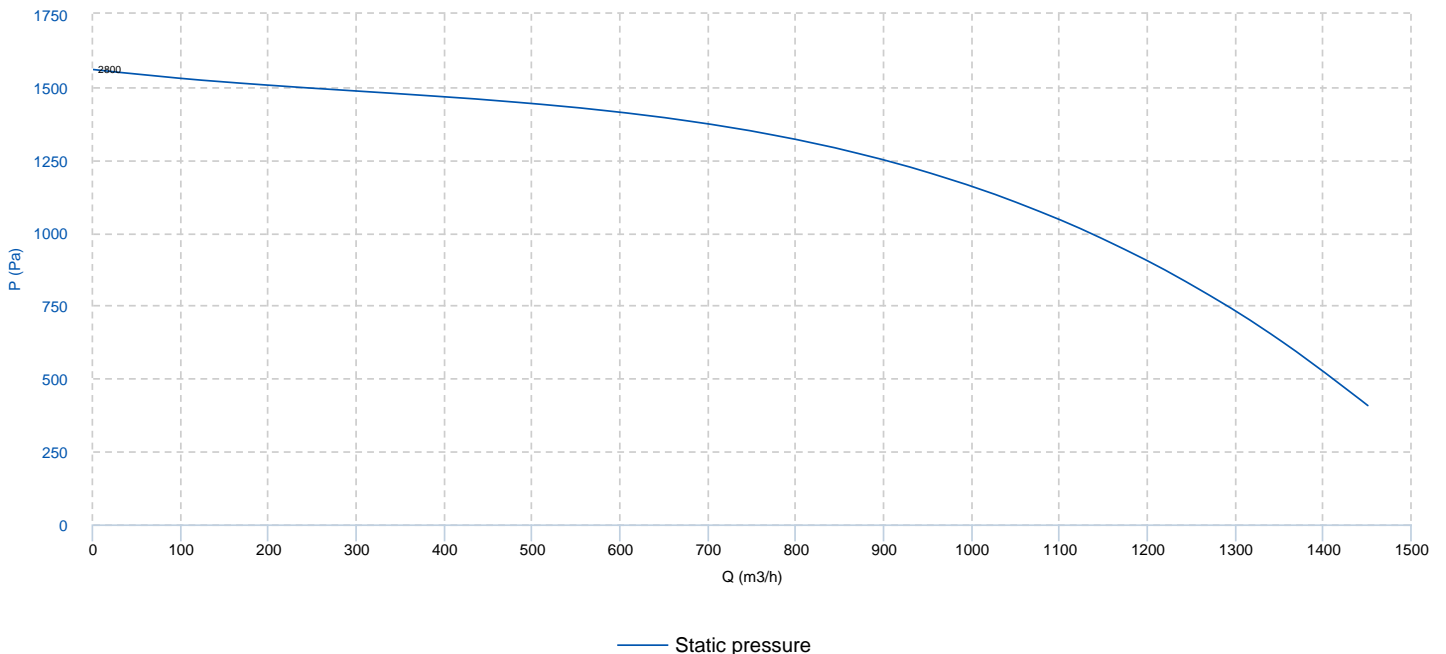

TECHNICAL DATA

fan

RPM	2830
-----	------

approx. weight	20 kg
----------------	-------

max flow	1450 m ³ /h
----------	------------------------

motor

power	1,1 kW
-------	--------

motor rpm	2830
-----------	------

imax 400V	2,6 A
-----------	-------

size	80
------	----

approx. weight	11 kg
----------------	-------

efficiency	72 %
------------	------

FP	0,86
----	------

DIMENSIONS DIAGRAM

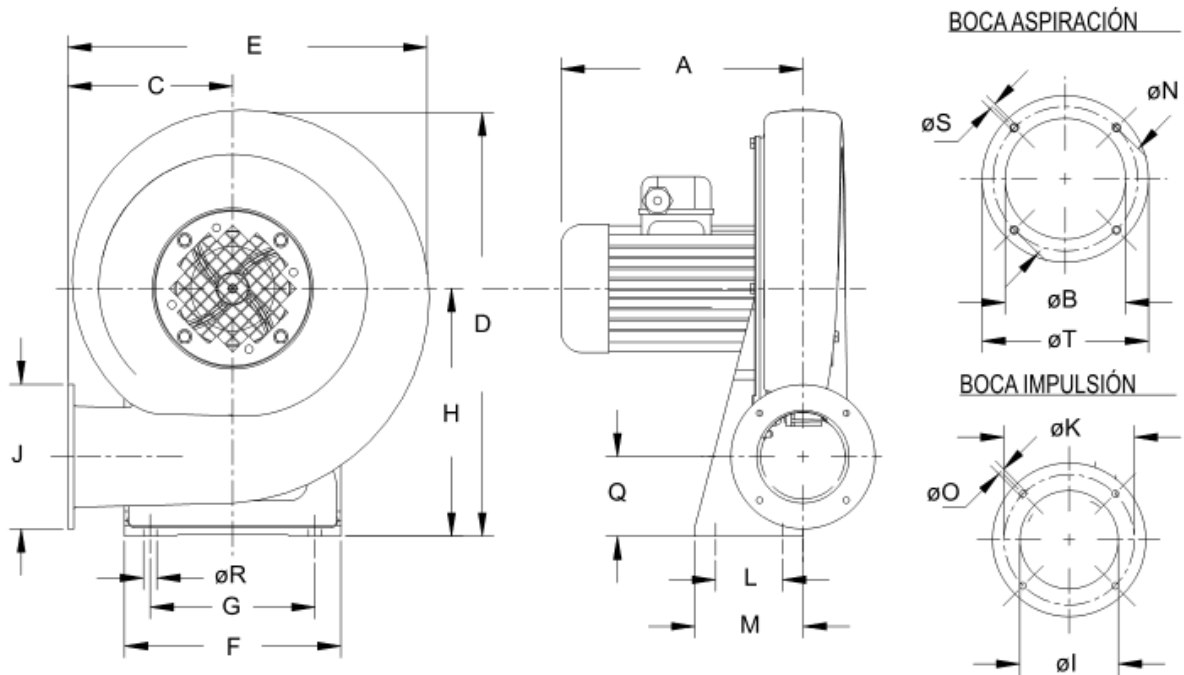

Dimensions (mm)

A	275
D2	468
E	393
J	182
OØ	10,2
TØ	187
Y	518

BØ	125
D3	605
F	230
KØ	160
P	20
U	518
Z	460

C	168
D4	558
G	166
L	100
Q	113
V	460

D	440
D5	516
H	290
M	140
RØ	13
W	406

D1	470
D6	505
IØ	130
NØ	162
SØ	6
X	393

MAX 31 T2 2,2kW (300886500)

GENERAL DATA



CENTRIFUGAL MEDIUM PRESSURE ATEX FAN

MANUFACTURING FEATURES

- Rolling steel sheet housing.
- Cast aluminium impeller.
- Epoxy powder finishing coat.
- Standard asynchronous squirrel-cage motor with IP-55 protection and Class F insulation and ATEX certified EEx-d. Manufactured with standard voltages: 230V 50Hz.
- Standard position LG 270.

APPLICATIONS

- Designed for inline installation, they are suitable for:
- General ventilation in closed environments classified as ATEX zone 2.
 - Maximum working temperature from -20°C to 80°C.

UNDER REQUEST

- 60Hz fans and special voltages.
- Position: LG 0, LG 45, LG 90, LG 135, LG 180 and LG 315.
- ATEX for different categories.

In compliance with the 94/9/CE Directive. ATEX II2G built. Certified II3G with certified ATEX EEx-d II2G motor for areas 2 (gas) or 22 (dust).

CHARACTERISCTIC CURVE

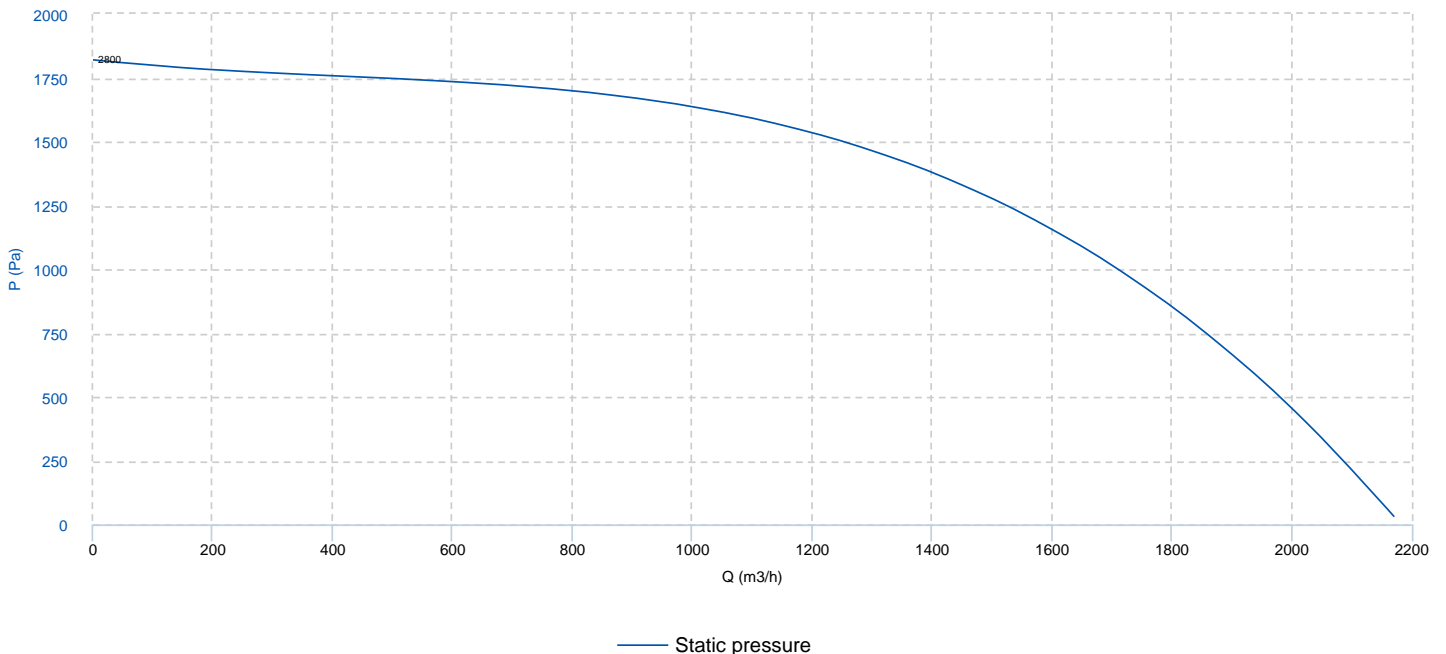

TECHNICAL DATA

fan

RPM	2840
-----	------

approx. weight	30 kg
----------------	-------

max flow	2170 m ³ /h
----------	------------------------

motor

power	2,2 kW
-------	--------

motor rpm	2840
-----------	------

imax 400V	5,4 A
-----------	-------

size	90L
------	-----

approx. weight	15 kg
----------------	-------

efficiency	70 %
------------	------

FP	0,85
----	------

DIMENSIONS DIAGRAM

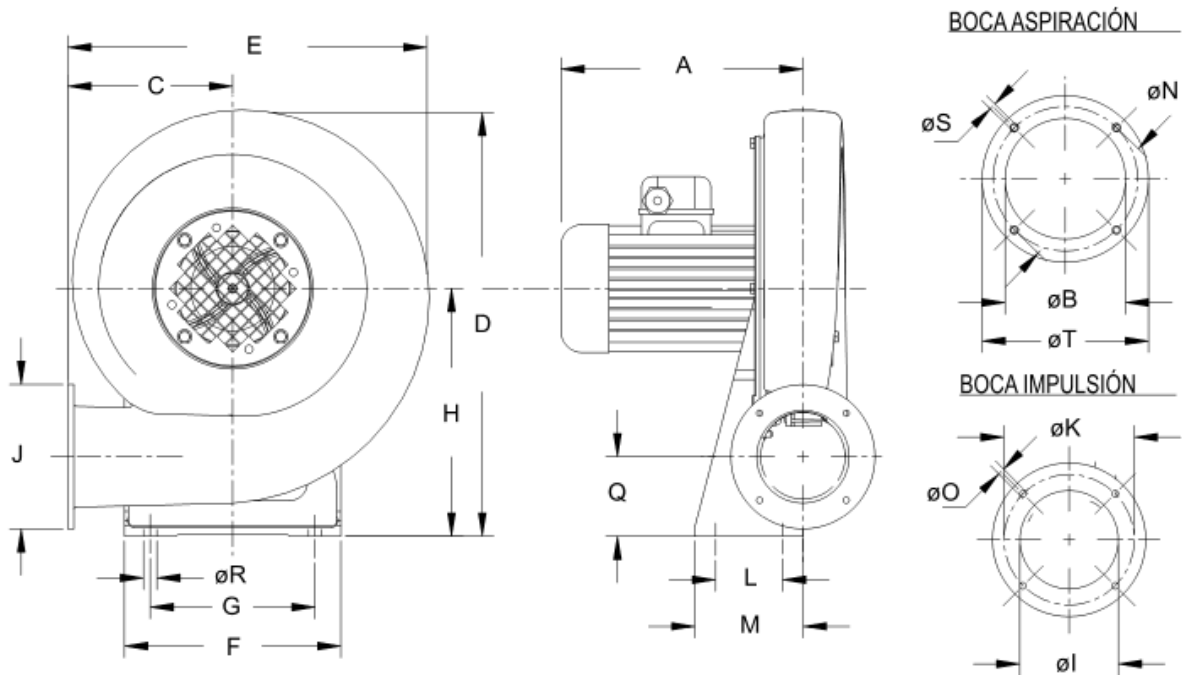

Dimensions (mm)

A	320
D2	513
E	428
J	200
OØ	10,2
TØ	215
Y	570

BØ	160
D3	668
F	240
KØ	175
P	18,5
U	570
Z	510

C	193
D4	620
G	190
L	120
Q	120
V	510

D	530
D5	568
H	320
M	160
RØ	13
W	445

D1	518
D6	555
IØ	140
NØ	180
SØ	6
X	428