

Suomen

EUROVAC

**IMURIKESKUS**

## Rita Cleaning- vacuum cleaners

*Use- and maintenance guide*



*This guide consist all knowledge you need for proper use of the device. Please, read this guide carefully before using the device and notice warnings. Keep this guide in safe.*

*Contents of this guide can be changed and improvements can be made without notice.*

## Table of contents

1. Introduction.....	4
2. Specifications and installation.....	4
2.1 Warnings.....	6
3. Using the device.....	6
3.1 Vacuuming dry trash.....	7
3.2 Vacuuming fluids.....	7
3.4 Using pre-separator.....	8
4. Maintenance while use.....	8
5. Troubleshooting.....	9
6. Warranty.....	9

## 1. Introduction

After receiving the device, check that it hasn't damaged in transport, and you've received all ordered items. If there's something to remind, we ask you to inform seller immediately or at least in eight (8) days.

This guide includes Rita Cleaning vacuum cleaners use- and maintenance operations. Please, read this guide carefully before using the device.

**NOTICE!** Device can be used to vacuum dry trash and fluids.

## 2. Specifications and installation

Following cleaning equipment are provided with the vacuum cleaner:

1. 5m suction hose with connectors
2. S-shape suction wand
3. Floor nozzle with brushes
4. Floor nozzle with rubber strips
5. Dust brush
6. Crevice Nozzle



Notice!

The crevice nozzle and dust brush will fit only into the hose connector.

The two parts of S-shape suction wand are joined together and then it forms S-shape suction wand.

The parts are joined together according to the following picture.



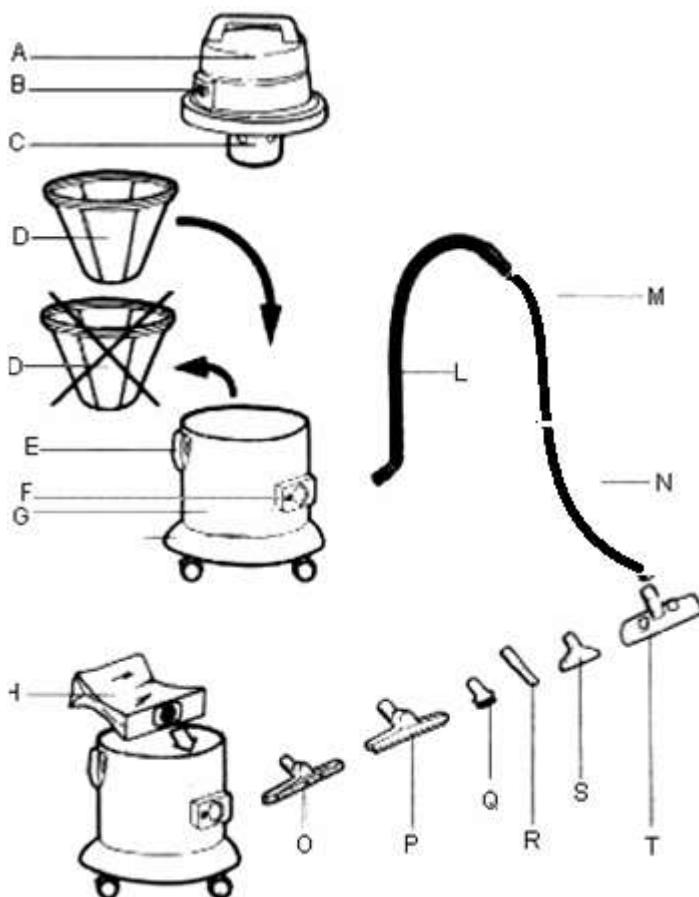

- A. Motor lid
- B. Switch
- C. Floater, it's important that motors don't be exposed to water.
- D. Polyester filter is attached to vacuum cleaner while vacuuming dry trash. Polyester filter must be removed before vacuuming fluids.
- E. Motor deck is installed with hatches to container
- F. Vacuum coupling
- G. Container
- H. Paper filter bag (accessory) is attached to vacuum tube coupling inside container. Paper filter bag can be used simultaneously with stock polyester filter.
- L. Flexible vacuum tube
- M. S-shape wand (part 1)
- N. S-shape wand (part 2)
- O. Water nozzle or combined water/dry nozzle\*
- P. Water nozzle\*
- Q. Round brush nozzle (PVC)
- R. Slit nozzle
- S. Textile nozzle (optional, not included)
- T. Multi-purpose nozzle (optional, not included)

**NOTICE!** Nozzles vary depending on model.  
Different types of filters available as accessories.

## 2.1 Warnings

- Don't use vacuum-cleaner in places, which might have easily flammable gases or substances
- Don't use vacuum cleaner to vacuum hot or glowing substances.
- Remove electric cable's plug from power outlet before starting maintenance operations.
- Don't let vacuum cleaner's motor lid get in touch with water.
- Don't use vacuum cleaner in rain or under splashing water.
- During vacuuming, be careful, that vacuum tube doesn't get close to sensitive areas of skin (eyes, mouth, ears).
- Don't leave vacuum cleaner on, when there's no-one around.
- Check that floater isn't damaged or stuck. If floater doesn't work water can get into motors and cause damage.
- If fluid leaks or foams from vacuum lid's output air holes, turn off vacuum cleaner immediately. Use specific caution to avoid danger of electric shock.
- Don't use too strong solvents or detergents in filter cleaning

## 3. Using the device

Following chapters presents using Eurovac – industrial vacuum depending on model and equipments. Before connecting electric cable, check that voltage you're going to use is same as shown in vacuum cleaner's specification plate.

**Important! To ensure best vacuum power, it's good to clean polyester and filter (stock) after every use time.**

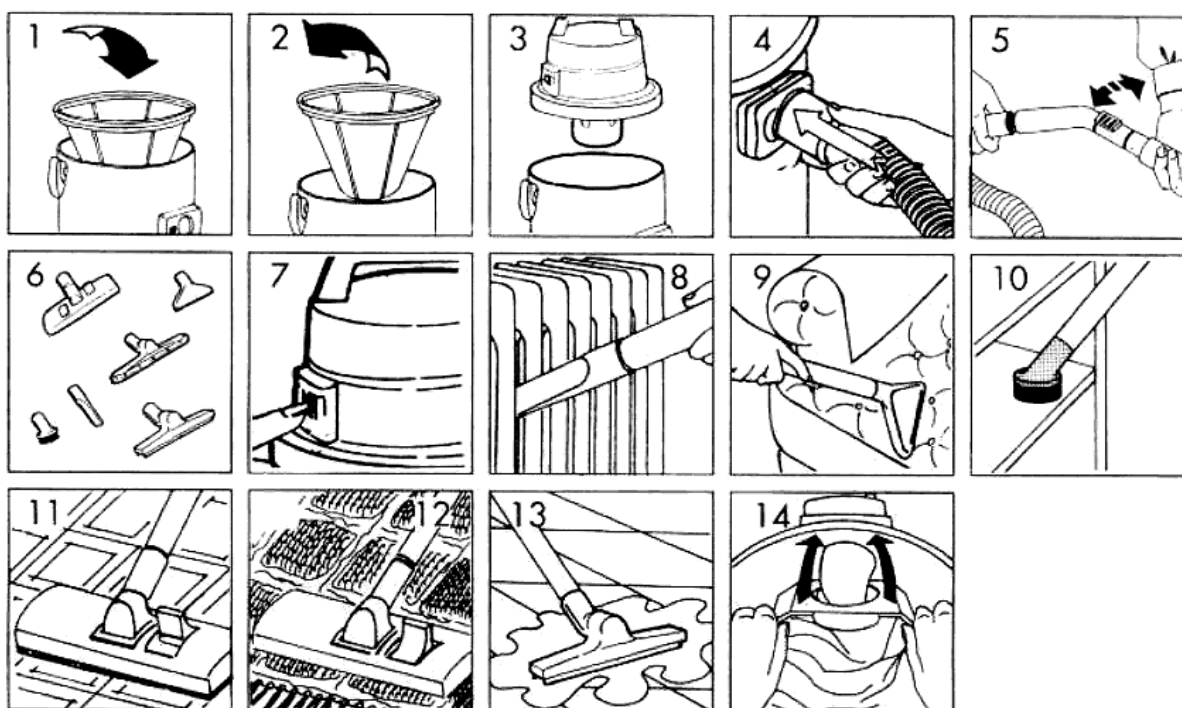

### **3.1 Vacuuming dry trash**

- Set stock filter to container (photo 1)
- Fasten container and motor lid with hatches (photo 3)
- Connect vacuum tube to coupling inside container (photo 4)
- Connect plastic tubes to other end of vacuum tube (photo 5)
- Select appropriate nozzle (photo 6)
- Connect power plug and turn on the vacuum cleaner (photo 7)
- For example. vacuuming with slit nozzle (photo 8)
- Use of round brush nozzle (photo 9)
- Use of floor nozzle (photo 11)
- Use of carpet nozzle (photo 12)
- While using paper filter, installed as shown in picture. (photo 14)

**NOTICE! When vacuuming extra fine dust for example ash/concrete dust, fine dust extra filter must be used**

### **3.2 Vacuuming fluids**

- Remove stock filter from container (photo 2)
- Fasten container and motor lid with hatches (photo 3)
- Connect vacuum tube to coupling inside container (photo 4)
- Connect plastic tubes to other end of vacuum tube (photo 5)
- Connect water nozzle (photo 6)
- Connect power plug and turn on the vacuum cleaner (photo 7)
- Use of water nozzle (photo 13)

**NOTICE! Always when vacuuming fluids, check that floater is in place and working correctly.**

### 3.4 Using pre-separator

When vacuum cleaner is equipped with pre-separator, device is using with pre-separator principle and most of the dust gathers to first container. First container's filling state must be observed to prevent trash going to actual vacuum cleaner.

Container must be emptied when it's half full, that ensures best separating ability. Glowing, burning and especially both materials mixed aren't recommended to vacuum with pre-separator. (ash and normal dust mixed).

When vacuuming hot ash, vacuuming must be done periodically to prevent vacuum tubes from melting. Vacuum ash 3 seconds and after that give cold compensation air outside ash space.

#### **Notice fire safety specifications!**

**NOTICE! Notice tube order.**

**NOTICE! Notice fire safety specifications.**



### 4. Maintenance while use

Following chapters include guides for maintenance actions, which should be done often enough to ensure device's long life. If you notice lack of vacuum power, clean filter by brushing, with compressed air or by washing with mild water (max. 40 °C ) or if necessary change it to new. Filter shape is recommended to check always while emptying container.

**NOTICE! Remove power plug from power outlet before maintenance!**

**NOTICE! Never use broken filter!**

**NOTICE! Newer use wet filter after washing!**

**NOTICE! Always before using check that filter is correctly installed!**

Remember to check time to time that vacuum cleaner's container hasn't overfilled. Container can be emptied after motor lid is removed from top of container.

Also cleaning kit's accessories with brushes need service time to time. Brushes can be cleaned by vacuuming with for example. slit nozzle.



## 5. Troubleshooting

### Device doesn't turn on

- Check, that switch/switches are in position "1
- Check, that electric cable is plugged (grounded, 230V)
- Check fuse 16A

### There's dust / dirt in output air

- Filter might be broken
- Filter isn't in place

### Weak vacuum power

- Check filter's cleanliness and integrity
- Check if vacuum tube is stuck
- Both motors aren't switched on

### Fuse burns

- Check, that fuse is right and big enough
- Take contact to manufacturer or seller

## 6. Warranty

Suomen Imurikeskus Oy grants twelve (12) months warranty for device according following terms. Warranty includes device- and manufacturing flaws. Warranty may void if device is modified, ownership changes or device is serviced in other than authorized service.

### WARRANTY TERMS

1. Warranty period begins when device is delivered to customer. Seller's deal receipt is accepted warranty certification.
2. If device is serviced during warranty period. Warranty time continues beginning from deliver time and doesn't start again.
3. Warranty doesn't include following matters:
  - Consuming parts, like brushes, motor coals, bearings, filter etc.
  - If device is used against use- and install instructions without filter or it's used to vacuum fluids or extra fine dusts.
  - Warranty doesn't cover motor breaks caused by lightning, overvoltage, etc.
  - Transport-. install, maintenance, etc costs.
  - Reckless use, transport damages or accident caused broke or flaw.
  - Warranty doesn't include wrong use or installation caused flaws.

## Maintenance memo

Model: \_\_\_\_\_ Day of first use \_\_\_\_\_

[illegible]



